

Trussed rafters at max 600mm c/c set out as shown on section, inc. diminishing set, size as manufacturers recommendations.

All cavities to be closed at eaves with insulation tucked into cavity void.

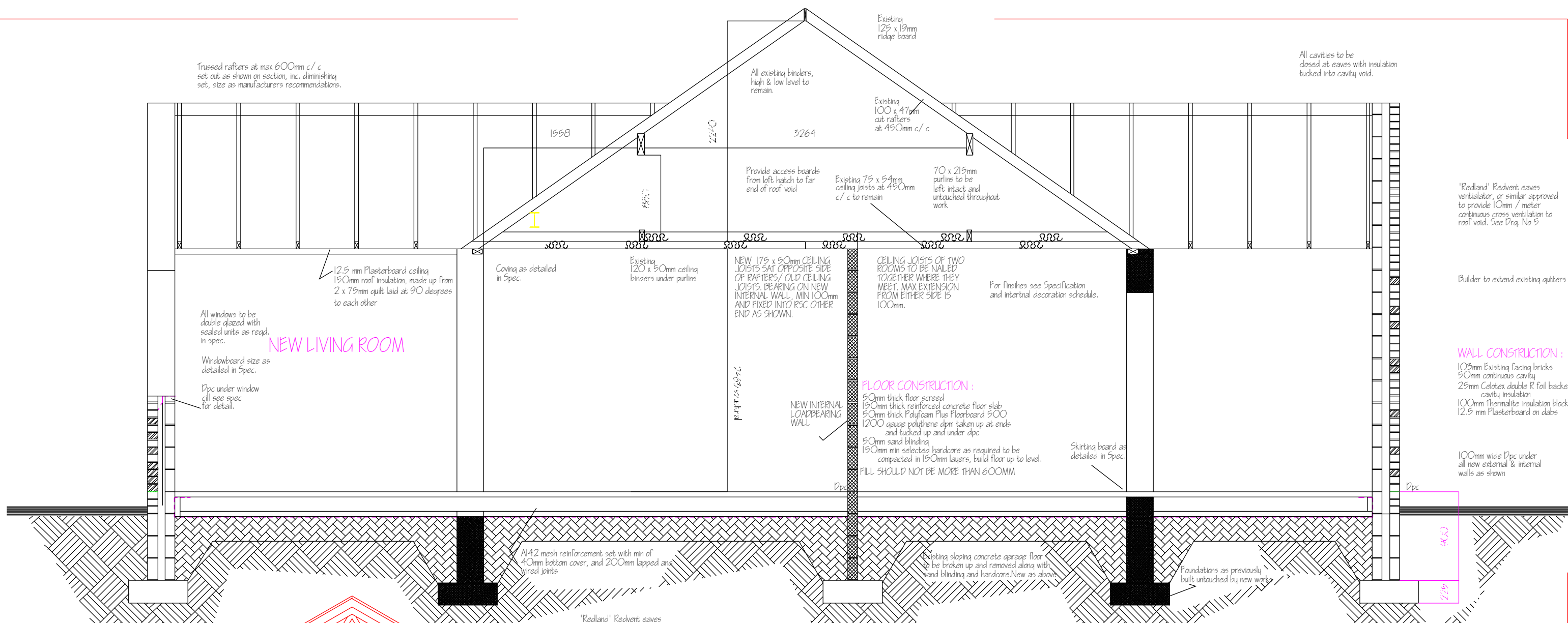

'Redland' Redvent eaves ventilator, or similar approved to provide 10mm / meter continuous cross ventilation to roof void. See Drg. No 5

Builder to extend existing gutters

**WALL CONSTRUCTION :**  
 105mm Existing facing bricks  
 50mm continuous cavity  
 25mm Celotex double R foil backed cavity insulation  
 100mm Thermalite insulation block  
 12.5 mm Plasterboard on dabs

100mm wide Dpc under all new external & internal walls as shown

### SECTION Y-Y

Provide crawl boards from left hatch to far end of roof void  
 All cavities to be closed at eaves with insulation tucked into cavity void.

'Redland' Redvent eaves ventilator, or similar approved to provide 10mm / meter continuous cross ventilation to roof void. See Drg. No 5  
 If above ventilation method does not work very well use tile vents at max 1.5m centres to give --- mm per metre cross ventilation run equivalent

DPC under gutter  
 Builder to remove gutter over old garage at front of property and use at rear sides as shown.  
 Copy / cast or obtain new to match existing profile section, size and colour.

**WALL CONSTRUCTION :**  
 105mm Existing facing bricks  
 50mm continuous cavity  
 20mm thick 'Celotex RR' cavity batt insulation  
 15mm thick insulation block  
 15mm Plasterboard on dabs

**FLOOR CONSTRUCTION :**  
 150mm thick concrete floor slab  
 50mm thick Polyfoam Plus Floorboard 500  
 1200 gauge polythene dpm taken up at sides and tucked under dpc  
 50mm sand blinding  
 150mm min selected hardcore

Foundations of new extension to be as deep as exiting and to as deep as required by building inspector

### Structural opening Schedule

ref	opening size	Level ref.	Level depth	Head height	CR height	Traffic ventilation
W1	1920 x 1290	0.361	2000	2250	2778	4000 mm sq.
W2	1290 x 1900	0.361	1900	2250	2778	4000 mm sq.
W3	1490 x 1900	0.361	1900	2250	2778	4000 mm sq.
W4	1770 x 1900	-	-	2250	2778	4000 mm sq.
D1	2402 x 2000	0.361	1900	2000	0	0
D2	2402 x 2028	0.361	1900	2000	2000	0
D3	2402 x 2028	-	-	2028	0	0
D4	2402 x 2028	-	-	2028	0	0

All heights taken from DPC, used as O Datum  
 Level rotation taken from Cable Lintel Manufacturer's Catalogue

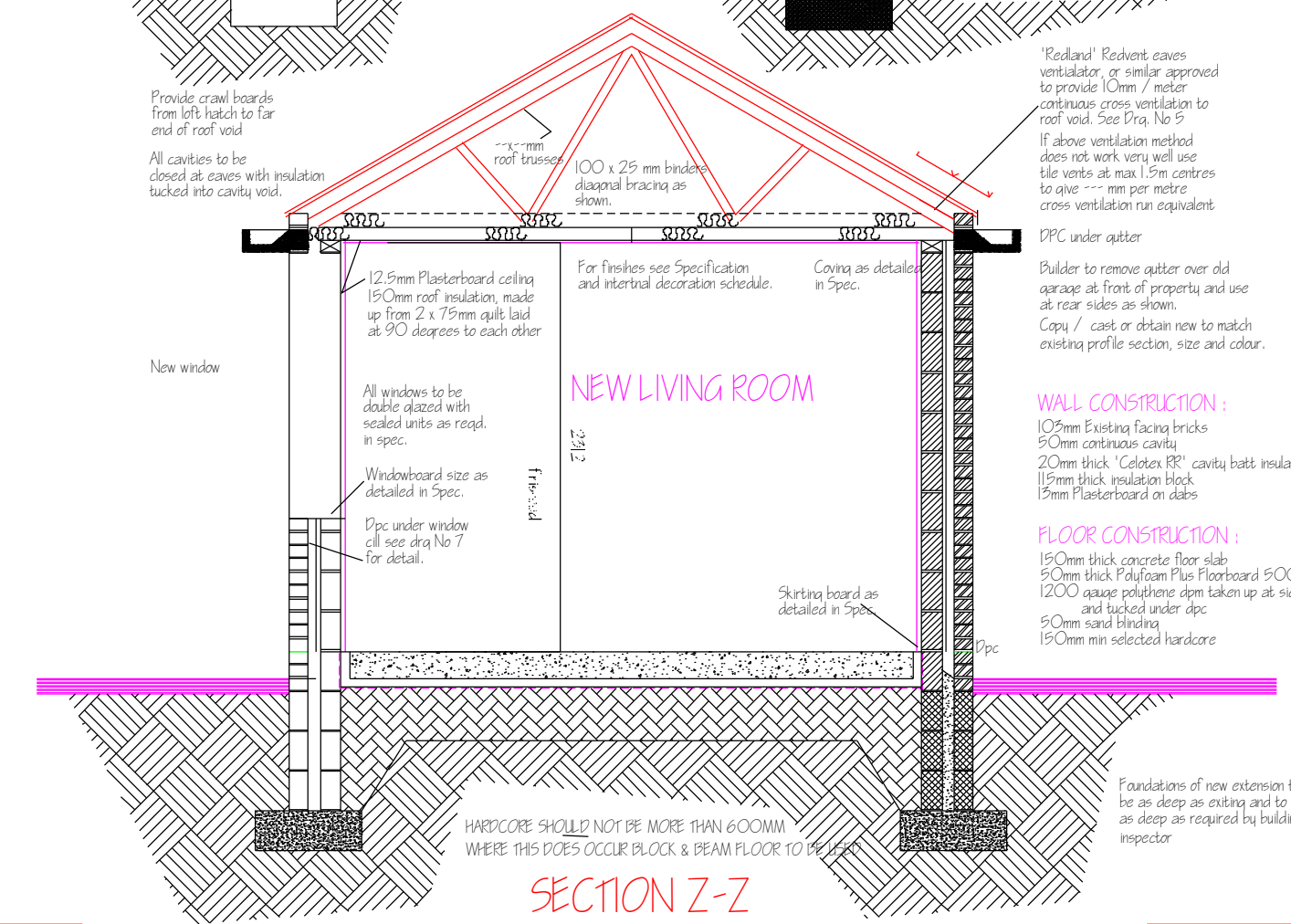

HARDCORE SHOULD NOT BE MORE THAN 600MM WHERE THIS DOES OCCUR BLOCK & BEAM FLOOR TO 150mm

### SECTION Z-Z

ANY ANOMALY BETWEEN APPROVED DRAWINGS AND SITE CONDITIONS, STATUTORY REQUIREMENTS OR OTHER REQUIREMENTS OF THE BUILDING INSPECTOR, INSPECTING ARCHITECT OR NHBC INSPECTOR SHALL BE RESOLVED BEFORE THE WORK IN QUESTION PROCEEDS. THIS DRAWING IS ISSUED TO IDENTIFY COMPONENTS AND TO SHOW METHODS OF CONSTRUCTION ONLY DO NOT SCALE. USE ONLY GIVEN DIMENSIONS

Location : Road Hallow, Worcester WR2	Client : Mr & Mrs W Proposed garage conversion and extension	Drawing title : BUILDING REGULATION DRAWING SECTIONS Date : Aprl.	Scale : 1:20	REV. <b>Drg. No: 05</b>
---	---	---	-----------------	----------------------------